



# **Solidcom C1 Pro – Roaming Hub**

## **Quick Guide**

V1.0

## Foreword

Thank you for choosing the Solidcom C1 Pro – Roaming Hub to facilitate your on-site communication. This **Quick Guide** will show you how to get started with the product.

# Product Overview

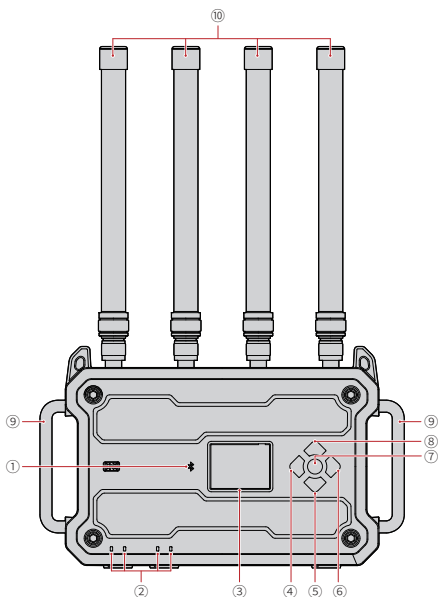

① Bluetooth Indicator

② IP Indicator

③ Display Screen

④ Left Button

⑤ Down Button

⑥ Right Button

⑦ Menu/Confirm Button

(Long press to enter menu;  
press to confirm)

⑧ Up Button

⑨ Handle

⑩ RF Antenna

## Product Overview

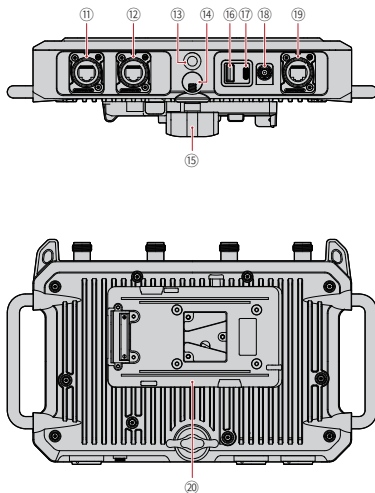

- ⑪ RJ45 Port 1
- ⑫ RJ45 Port 2
- ⑬ 3/8" Threaded Hole
- ⑭ 5/8" Mount Hole
- ⑮ Limit Knob
- ⑯ USB-A Port (for headset pairing)
- ⑰ USB-C Port (for UAC audio)
- ⑱ DC Input
- ⑲ RJ45 Port 3 (4-wire)
- ⑳ V/G-Mount Battery Plate

# Pinout Introduction

## RJ45 1/2 Pinout

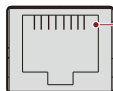

PIN1-PIN8

RJ45

Standard Pinout			
PIN1	Transceive Data+	PIN5	Not connected
PIN2	Transceive Data-	PIN6	Receive Data-
PIN3	Receive Data+	PIN7	Not connected
PIN4	Not connected	PIN8	Not connected

## RJ45 3 Pinout

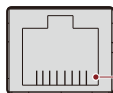

PIN1-PIN8

4 WIRE

Standard Pinout			
PIN1	GND	PIN5	AUDIO OUT-
PIN2	GND	PIN6	AUDIO IN-
PIN3	AUDIO IN+	PIN7	GND
PIN4	AUDIO OUT+	PIN8	GND

Crossover Pinout			
PIN1	GND	PIN5	AUDIO IN-
PIN2	GND	PIN6	AUDIO OUT-
PIN3	AUDIO OUT+	PIN7	GND
PIN4	AUDIO IN+	PIN8	GND

# Home Page Introduction

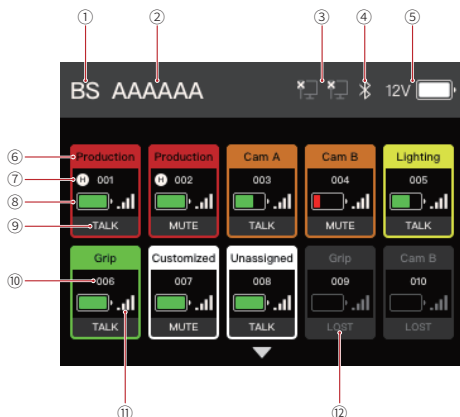

- ① Hub ID
- ② Hub Name
- ③ Hub Connection Status (PC connection/IP connection)
- ④ Bluetooth Status (white: on; gray: off)
- ⑤ Power Voltage and Battery Level
- ⑥ Headset Role
- ⑦ Head Indicator
- ⑧ Headset Battery Level
- ⑨ Headset Talk/Mute/Lost Status
- ⑩ Headset Number
- ⑪ Signal Strength
- ⑫ Unconnected Headset

## Product Installation

1. Install the antennas as shown in the diagram.

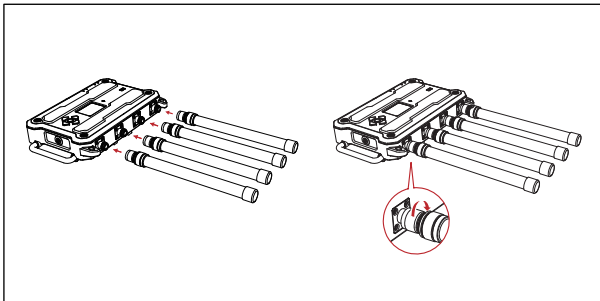

2. Install the battery or connect the power adapter.

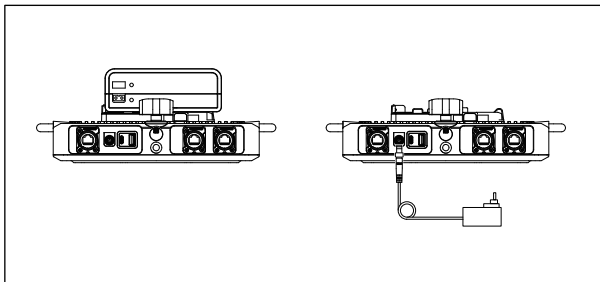

## Product Installation

3. Mount the Hub on the tripod and secure it.

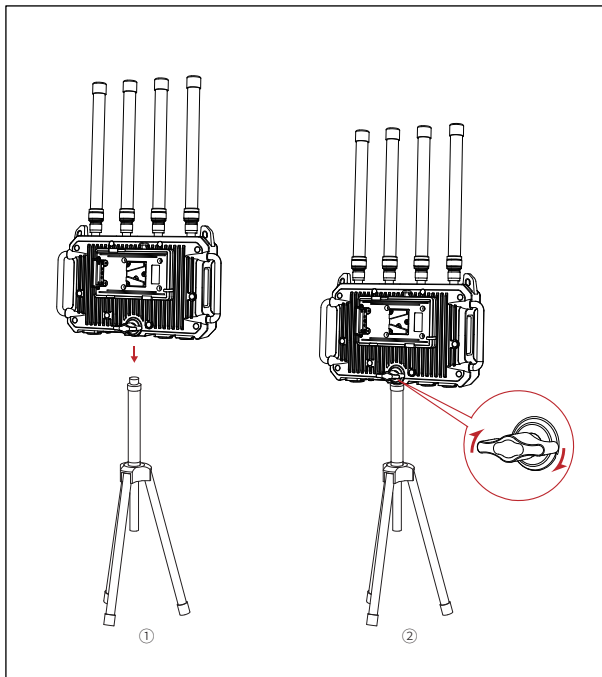



## Product Connection

### Single Hub Connection

#### Condition One

For headsets in the Solidcom C1 Pro – Roaming Hub package, since the Hub and headsets have already been paired at the factory, they can be used immediately after power-on.

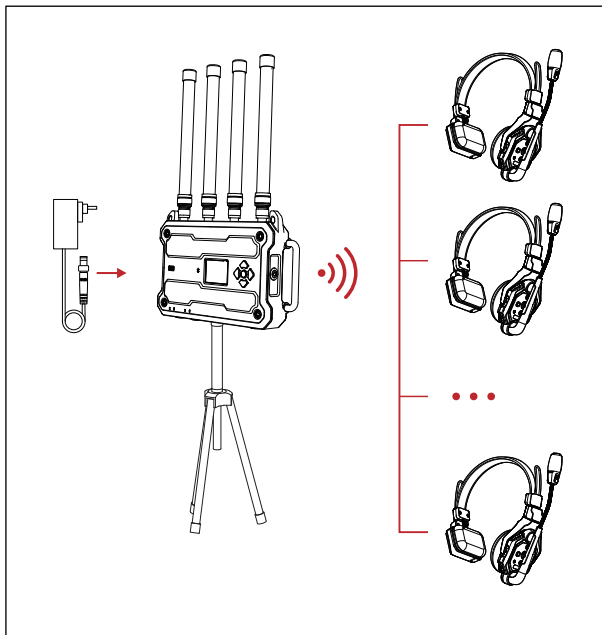

## Product Connection

### Condition Two

For previously purchased Solidcom C1 and Solidcom C1 Pro headsets, the Hub and headsets need to be manually paired before use. The pairing procedures are as follows.

1. Power on the Hub and headset, and then use a USB-A to USB-C cable to connect them.

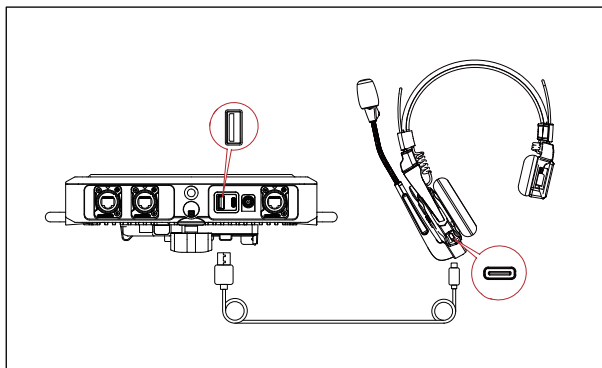

2. A pop-up window appears, indicating a firmware version mismatch. Choose **Yes** to upgrade the headset.

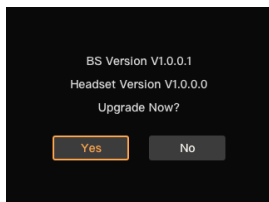

## Product Connection

3. After the upgrade is complete, a pop-up window appears on the Hub, prompting you to assign a number to the pairing headset. Numbers in yellow are in use and hence not selectable, while numbers in gray are selectable. Select an appropriate number and choose **Confirm** to complete the pairing process.



# Product Connection

## Dual Hub Cascade Connection

To ensure that headsets maintain connection across the signal areas of two cascaded Hubs connected via an RJ45 Port, strictly follow the steps below for a reliable cascade connection.

1. Before cascading the Hubs, power on all headsets and Hubs to be used. Ensure that all headsets remain powered on until the cascade connection is successfully established.

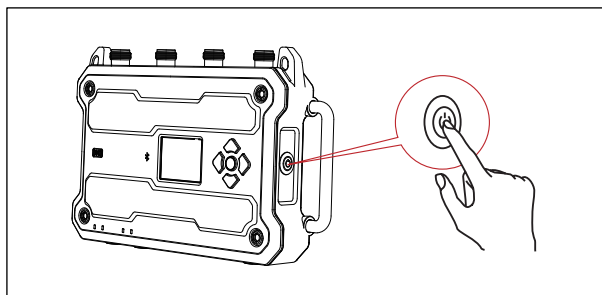
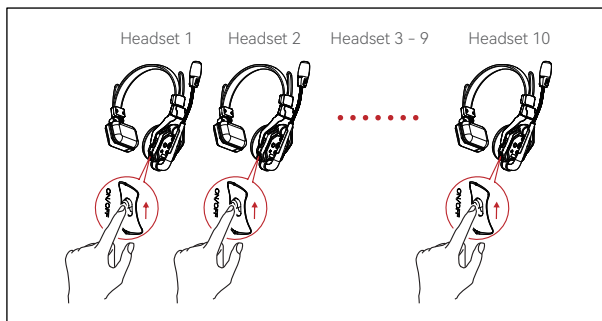

## Product Connection

2. When all headset indicators stop flashing and display a steady light, it indicates that the headsets have successfully connected to the respective Hub. Then, you can connect the Hubs using an Ethernet cable as shown in the diagram.

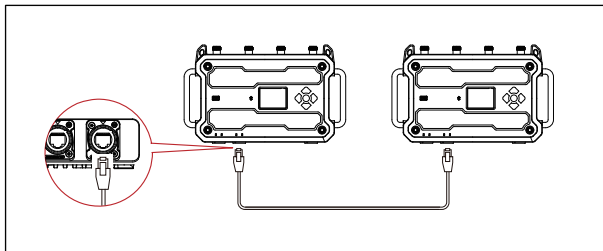

**Note:** Ensure that all headsets are powered on and connected to the corresponding Hub before cascading the Hubs.

## Group Configuration on Hub

The Hub supports 6-group talking and role assignment. You can assign a specific type of role to each headset and configure the parameters for each type through the Hub, webpage, or app, thus obviating the need to manually configure each headset's parameters. The procedures for group configuration on the Hub are as follows.

1. Long press the menu button on the Hub to enter the Menu interface.

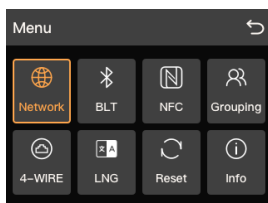

2. Select **Grouping** to enter the Group Settings interface. Choose **Customization** to customize the number for each type of role.

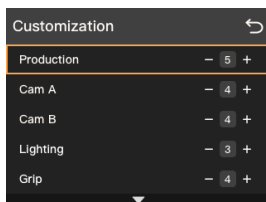
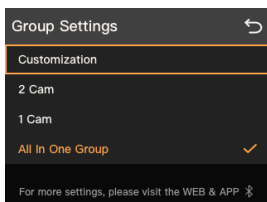

## Operation

3. The Hub supports a total of 10 preset roles: Production (head/member), Cam A (cameraman group A head/member), Cam B (cameraman group B head/member), Lighting (head/member), Grip (equipment team head/member). Each role's group and corresponding button (A/B) are in the table below.

Role	Group 1	Group 2	Group 3	Group 4	Group 5	Group 6
Production (head)	A					
Production (member)	A					
Cam A (head)	A	B				
Cam A (member)		B				
Cam B (head)	A		B			
Cam B (member)			B			
Lighting (head)	A			B		
Lighting (member)				B		
Grip (head)	A				B	
Grip (member)					B	

4. Adjust the number for each type of role based on your actual needs, and select Auto-Gen to save and apply the configuration to the headsets. For example, If you set the number for Production to 5, headsets 1-5 will be assigned to Production. If you set the number for Cam A to 4, headsets 6-9 will be assigned to Cam A, and so forth.
5. Distribute the headsets to the corresponding personnel and start work.

### ■ Hub Configuration on App

1. Download the Solidcom app.



2. Turn on your phone's Bluetooth, search for the device beginning with HLD, and click it to connect.
3. Launch the Solidcom app, wait for the software to fully load, tap **Connect** and then begin to configure the Hub.



# Operation

## Hub Upgrade

**Note:** You can obtain the firmware upgrade file from Hollyland's official website or by contacting Hollyland online technical engineers.

1. Use a standard RJ45 Ethernet cable to connect the Hub to your computer.

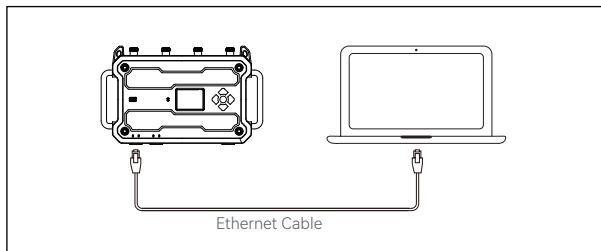

2. Set your computer's IPv4 information to be on the same subnet as the Hub, open the default browser, and enter the Hub's IP address to navigate to the login page.



Welcome back  
**Login to your account**

User

Password

其他

3. Enter the default username admin and password 12345678 or your custom username and password to log in, click **Other > Settings** to jump to the upgrade page, upload the firmware file, and click **Upgrade** to initiate the upgrade process.

# Specifications

	Hub
LOS Range	1,600ft (500m)
Operating Frequency	1904 – 1919 MHz: China 1880 – 1900 MHz: Europe, South Africa, much of Asia, Hong Kong SAR, Australia, and New Zealand (10 channels) 1880 – 1895 MHz: Taiwan (8 channels) 1893 – 1906 MHz: Japan (J-DECT) 1910 – 1920 MHz: Brazil (10 channels) 1910 – 1930 MHz: Much of Latin America excluding Brazil. 1920 – 1930 MHz: USA & Canada
Transmit Power	≤ 21 dBm
Bandwidth	1.728 MHz
Modulation Mode	GFSK
Frequency Response	100 Hz – 7 kHz (±3dB) @1 kHz
Receiver Sensitivity	≤ -90 dBm
SNR	> 55dB
Antenna Gain	4 dBi (all directions)
DC Voltage Range	7 – 30V, < 1A@12V
V/G Mount Battery Voltage Range	11 – 30V, < 1A@12V
Power Consumption	< 1A@12V
Dimensions	302mm × 181.52mm × 63.6mm
Weight	1797.5g (63.4oz)
Temperature Range	-10 – 45°C (working) -20 – 60°C (storage)

## Safety Precautions

Do not place the device near or inside heating devices (including but not limited to microwave ovens, induction cookers, electric ovens, electric heaters, pressure cookers, water heaters, and gas stoves) to prevent the battery from overheating and exploding. Use the original charger, data cables, and batteries provided with the product. Using unauthorized or incompatible chargers, data cables, or batteries may cause electric shock, fire, explosion, or other dangers.

If you encounter any problems in using the product or need any help, please contact Hollyland Support Team via the following ways:

 Hollyland User Group

 HollylandTech

 HollylandTech

 HollylandTech

 support@hollyland.com

 www.hollyland.com

## Statement

All copyrights belong to Shenzhen Hollyland Technology Co., Ltd.

## Trademark Statement

Without the written approval of Shenzhen Hollyland Technology Co., Ltd., no organization or individual may copy or reproduce part or all of any written or illustrative content and disseminate it in any form.

## Note:

Due to product version upgrades or other reasons, this **Quick Guide** will be updated from time to time. Unless otherwise agreed, this document is provided as a guide for use only. All representations, information, and recommendations in this document do not constitute warranties of any kind, express, or implied.

# **HOLLYVIEW**

Powered by Hollyland

---

**Shenzhen Hollyland Technology Co., Ltd.**

8F, 5D Building, Skyworth Innovation Valley,  
Tangtou Road, Shiyan Street, Baoan District, Shenzhen, 518108, China

MADE IN CHINA