



# **Solidcom SE**

## **Quick Guide**

V1.0



## Foreword

Thank you for choosing the **Solidcom SE** for on-site communication. If you have never used a wireless intercom system before, then you are about to experience one of the most exciting products in the industry. This Quick Guide will show you how to get started with the product.

**EN** Please read this Quick Guide carefully. We wish you a pleasant experience. To obtain Quick Guide information in other languages, please scan the QR code below.



## Configuration



Master Headset (Brown)



Remote Headset (Black)

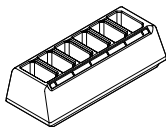

6-Slot Charging Base



Li-ion Battery Pack 770

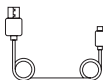

USB-A to USB-C Cable



Number Stickers 01

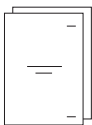

Quick Guide & Packing  
List Card



Warranty Card &  
Compliance Information

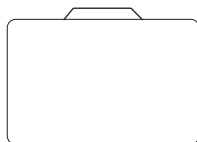

Carrying Case

Note: The quantity of the items depends on the product configuration detailed on the packing list card.

# Overview

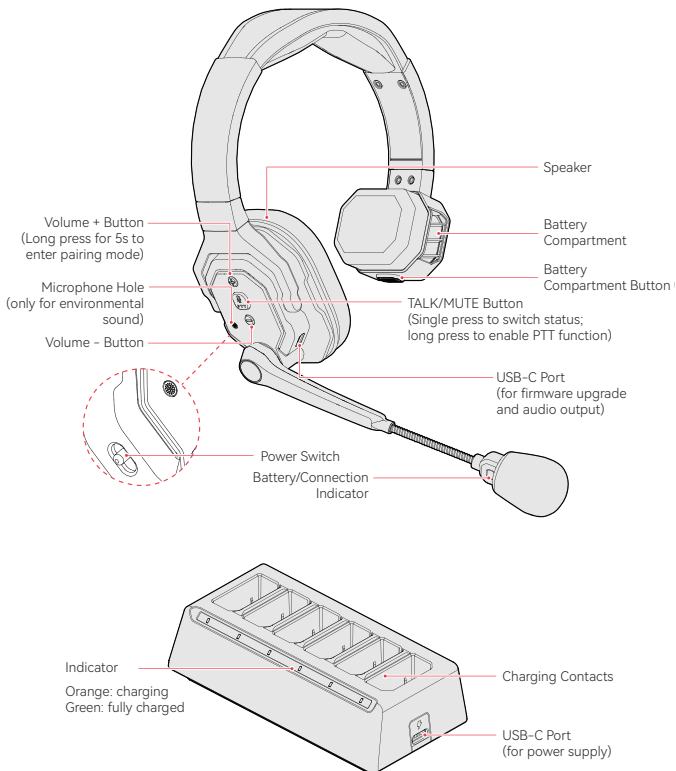

## Indicator Introduction

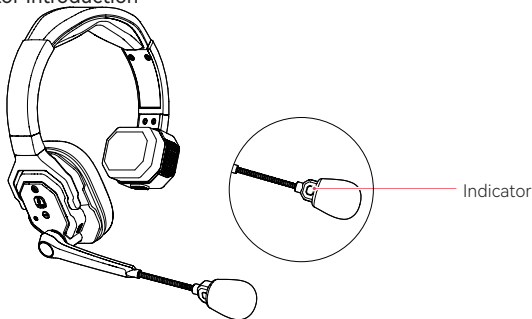

- ① Disconnected\*: slowly flashing green light
- ② Pairing: rapidly flashing green light
- ③ TALK Status: solid green light
- ④ MUTE Status: solid red light
- ⑤ Low Battery: slowly flashing red light
- ⑥ USB-C Charging:
  - A. Charging While Powered On: slowly flashing yellow light for 3s before returning to the former light
  - B. Charging While Powered Off: slowly flashing yellow light
- ⑦ USB-C Fully Charged: solid yellow light
- ⑧ Upgrading: alternately flashing red and green light

## Notification Sound Introduction

- ① Low Battery: low battery level
- ② Ding: maximum volume
- ③ Tick: mic boom in position of mic on or off
- ④ Connected: device connected
- ⑤ Disconnected: device disconnected
- ⑥ Unmuted: mic on
- ⑦ Muted: mic off

\* While disconnected, the remote headset shows slowly flashing green light while the master headset shows solid green light.

# Operations

## ① Installing and removing the battery

■ Place the battery into the battery compartment for installation.

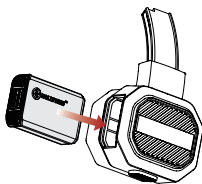

■ Press the battery compartment button to pop out the battery for removal.

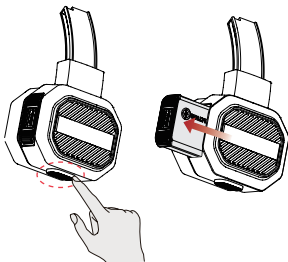

## ② Turning on the device and confirming connection

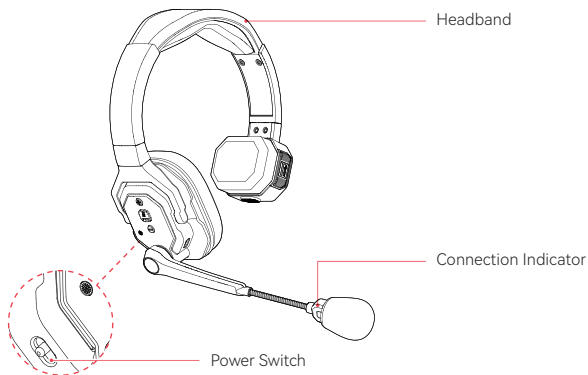

1. Toggle the power switch to turn on the headsets.
2. The indicator light changing from flashing green to solid green indicates successful connection.
3. The master headset has a brown headband while the remote headset has a black headband.

## ③ Turning on the microphone

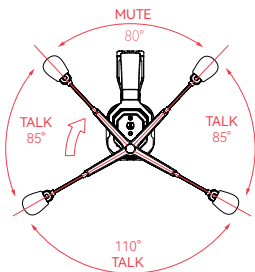

Clockwise

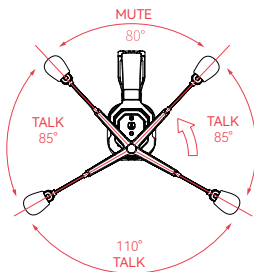
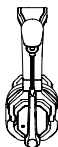

Counterclockwise

## ④ Beginning your work

### Headset Pairing

All remote headsets are prepared with the master headset at the factory, so they are ready to use upon poweron. Pairing is only necessary when adding new headsets to an existing system. Ensure that the master headset and all remote headsets are powered on while pairing.

1. Long press the volume + button on both the master and remote headsets for 5s and the indicator lights will flash rapidly.
2. The indicator lights turning solid indicates successful connection.
3. One master headset can connect to up to seven remote headsets.

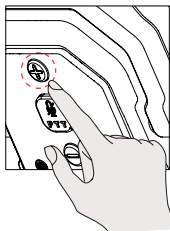



## Specifications

Product Name	Solidcom SE Single-Ear Headset
LOS Range	1,100ft (350m)
Operating Frequency	2.4 GHz
Modulation Mode	GFSK
Transmit Power	≤ 20dBm
Receiver Sensitivity	-92 dBm
Battery Capacity	770 mAH (2.926Wh)
Charging Time	< 3 hours
Frequency Response	150 Hz - 7 kHz (±10dB)
SNR	>70dB @94dB SPL, 1kHz
Distortion	< 1% @94dB SPL, 150 Hz - 7 kHz
Microphone Type	Electret
Maximum Input SPL	> 115dB SPL
Output SPL	98dB SPL (@94dB SPL, 1kHz)
Environmental Noise Reduction	> 20dB (from all directions)
Weight	≈ 185.2g (with battery)
Battery Life	10h
Temperature	0 - 45°C (working) -10 - 60°C (storage)

Note: Due to differences in various countries and regions, there may be variations in the operating frequency and wireless transmit power of the product.

## Specifications

Product Name	6-Slot Charging Base
Port	USB-C Port; Charging Contacts
Dimensions	119.3 × 57.6 × 34.6mm (4.7 × 2.3 × 1.4in.)
Weight	91.1g
Charging Power	≤ 10W
Power Supply	4.75 - 5.25V
Charging Current	≤ 380mA/Slot
Charging Time	< 3 hours (6 batteries)
Temperature	0 - 45°C (working) -20 - 60°C (storage)

## Safety Precautions

Do not place the device near or inside heating devices (including but not limited to microwave ovens, induction cookers, electric ovens, electric heaters, pressure cookers, water heaters, and gas stoves) to prevent the battery from overheating and exploding. Use the original charger, data cables, and batteries provided with the product. Using unauthorized or incompatible chargers, data cables, or batteries may cause electric shock, fire, explosion, or other dangers.

## Support

If you encounter any problems in using the product or need any help, please contact Hollyland Support Team via the following ways:



Hollyland User Group



HollylandTech



HollylandTech



HollylandTech



support@hollyland.com



www.hollyland.com

## Statement:

All copyrights belong to Shenzhen Hollyland Technology Co., Ltd. Without the written approval of Shenzhen Hollyland Technology Co., Ltd., no organization or individual may copy or reproduce part or all of any written or illustrative content and disseminate it in any form.

## Trademark Statement:

All the trademarks are owned by Shenzhen Hollyland Technology Co., Ltd.

## Note:

Due to product version upgrades or other reasons, this Quick Guide will be updated from time to time. Unless otherwise agreed, this document is provided as a guide for use only. All representations, information, and recommendations in this document do not constitute warranties of any kind, express or implied.

# **HOLLYVIEW**

**Powered by Hollyland**

**Manufacturer:** Shenzhen Hollyland Technology Co., Ltd.

**Address:** 8F, 5D Building, Skyworth Innovation Valley, Tangtou Road, Shiyan Street, Baoan District, Shenzhen, 518108, China

**MADE IN CHINA**

P/N:3003080632