



COSMO M7

User Manual

HOLLYVIEW

Powered by Hollyland

DESCRIPTION

Thank you for purchasing COSMO M7 wireless monitor system. The product uses the latest wireless technology in the industry. It is widely used in mobile monitoring, mobile follow focus, etc. It has a zero-compression and zero-latency transmission range over 600ft with a clean line of sight (LOS) when it connects with the COSMO 2000 transmitter. It supports up to 1080P 60Hz image resolution, and in the end achieves full HD HDMI video transmission.

KEY FEATURES

■ IMONITOR

- 7" High Brightness Touchscreen Wireless Monitor
- 1500 Nits
- Support Touch Screen
- Support Focus Assist and Adjustable Intensity
- Support Exposure Assistance
- Support Pseudo Color & Zebra & HDR
- Support Waveform / Vector / Histogram
- Support 3D LUT & TC Code
- 178 ° Viewing Angle
- 7 ~ 36V DC Wide Voltage Input
- Stable & Reliable Industrial Metal Case with Wooden Handle

■ WIRELESS VIDEO TRANSMISSION

- 1080P60Hz
- Support Channel Scan
- No Compression, No Latency
- Support 3.5mm Audio Output Interface
- USB Firmware Upgrade
- Compatible with All COSMO Products

DESCRIPTION

APPLICATIONS

- Film Shooting
- Drama Shooting
- Commercial Shooting

SINGLE MONITOR PACKING

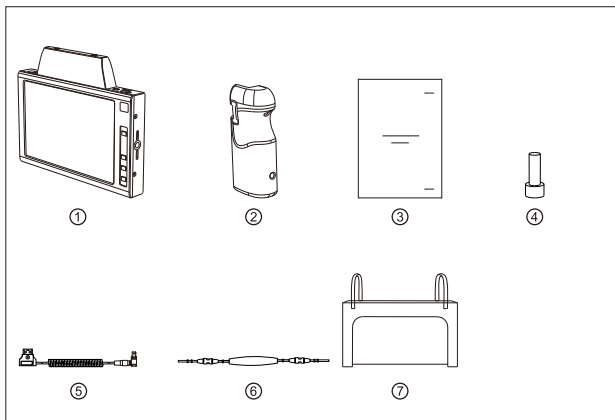

- | | |
|--------------------------------|----|
| ① Wireless Monitor | x1 |
| ② Wooden Handle | x2 |
| ③ User manual | x1 |
| ④ M3 * 8 Socket Head Cap Screw | x4 |
| ⑤ D-Tap to Lemo Spring Cable | x1 |
| ⑥ Neck Strap | x1 |
| ⑦ Screen Hood | x1 |

MONITOR & TRANSMITTER SET PACKING

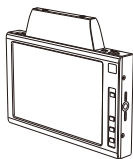

①

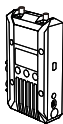

②



③



④



⑤



⑥



⑦



⑧



⑨

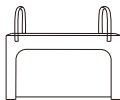

⑩



⑪



⑫

MONITOR & TRANSMITTER SET PACKING

Different suits have different TX (as shown in), and the illustration takes COSMO 2000 as an example.

① Monitor	x1
② Transmitter	x1
③ Wooden Handle	x2
④ User manual	x1
⑤ 5GHz Antenna	x3
⑥ Mushroom Antennal	x2
⑦ 7" Magic Arm	x1
⑧ Crab Clamp	x1
⑨ M3 * 8 Socket Head Cap Screw	x4
⑩ Screen Hood	x1
⑪ D-Tap to Lemo Spring Cable	x2
⑫ Neck Strap	x1

TYPICAL SETUP

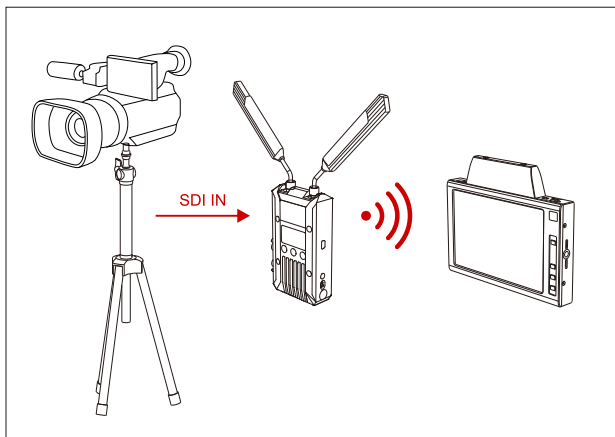

This wireless HD video transmission system uses the latest wireless communication technology, and can realize no-compression and zero-latency wireless video transmission range over 600ft. With our COSMO series transmitter, it can easily achieve mobile monitoring and focus pulling.

TYPICAL SETUP

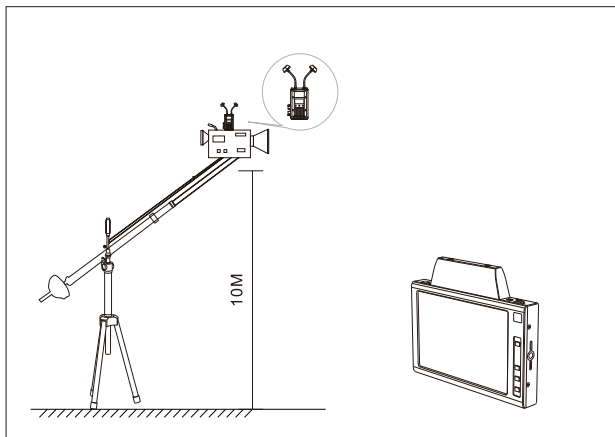

The package packing comes with the COMSO 2000 transmitter and mushroom antennas. When there is a huge height difference between the transmitter and the

PRODUCT INTERFACES

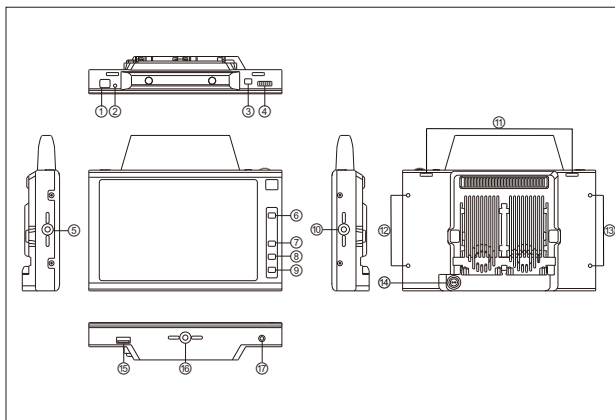

- | | |
|-----------------------|------------------------|
| ① Power Switch | ⑩ 1 / 4 Screw Hole |
| ② Power Indicator | ⑪ Neck Strap Hole |
| ③ Exit | ⑫ Handle Mounting Hole |
| ④ Menu | ⑬ Handle Mounting Hole |
| ⑤ 1 / 4 threaded hole | ⑭ DC Input |
| ⑥ F1 Shortcut | ⑮ USB Interface |
| ⑦ F2 Shortcut | ⑯ 1 / 4 Screw Hole |
| ⑧ F3 Shortcut | ⑰ 3.5mm Headphone Hole |
| ⑨ Channel Shortcut | |

MENU DESCRIPTION

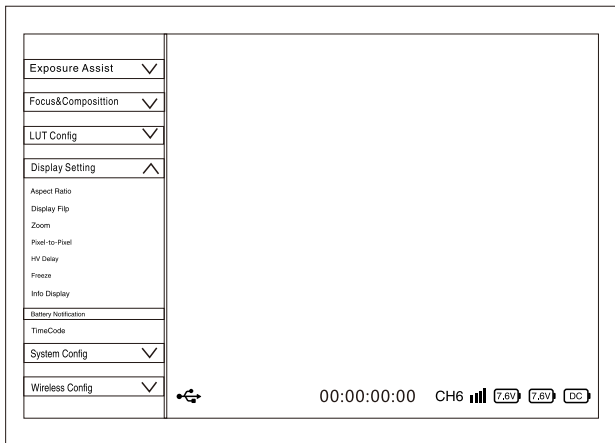

MENU DESCRIPTION

Exposure Assist

False Color	→	Close	SPECTRUM	ARRI										
Zebra	→	Close	<input type="range"/> IRE		<table border="1"> <tr><td></td><td></td><td></td></tr> <tr><td></td><td>Position</td><td></td></tr> <tr><td></td><td></td><td></td></tr> </table>					Position				
	Position													
Histogram	→	Close	Brightness	RGB	<table border="1"> <tr><td></td><td></td><td></td></tr> <tr><td></td><td>Position</td><td></td></tr> <tr><td></td><td></td><td></td></tr> </table>					Position				
	Position													
Waveform	→	Close	Luminance	RGB	<table border="1"> <tr><td></td><td></td><td></td></tr> <tr><td></td><td>Position</td><td></td></tr> <tr><td></td><td></td><td></td></tr> </table>					Position				
	Position													
Vectorscope	→	Close	Open		<table border="1"> <tr><td></td><td></td><td></td></tr> <tr><td></td><td>Position</td><td></td></tr> <tr><td></td><td></td><td></td></tr> </table>					Position				
	Position													
All Wave	→	Close	Open											
HDR	→	Close	HLG	PQ										

Focus&Composition

Single Color	→	Close	<input type="checkbox"/>	<input type="checkbox"/>	<input type="checkbox"/>	<input type="checkbox"/>
Peaking	→	Close	<input type="checkbox"/>	<input type="checkbox"/>	<input type="checkbox"/>	<input type="checkbox"/>
		Weak	Average		Strong	
		<input type="range"/>				
		Strength				
Center Mark	→	Close	Open	<input type="checkbox"/>	<input type="checkbox"/>	<input type="checkbox"/>
Safe Area	→	Close	<input type="range"/> 80% 85% 90% 93% 95%			
			<input type="checkbox"/>	<input type="checkbox"/>	<input type="checkbox"/>	<input type="checkbox"/>
Mark Ratio	→	Close	<input type="range"/> 4:3 16:10 16:9 1.85:1 2.35:1 2.39:1			
		Off	L	H	<input type="checkbox"/>	<input type="checkbox"/>
		Transparency				
Grid Lines	→	Close	<input type="range"/> 2X2 3X3 4X4 5X5 6X6 7X7 8X8			
			<input type="checkbox"/>	<input type="checkbox"/>	<input type="checkbox"/>	<input type="checkbox"/>
Audio Meters	→	Close	Left	Right		

MENU DESCRIPTION

LUT Config

LUT → Close Open 2800 Kelvin - 3200 Kelvin - 0

Custom LUT_usb → USB Look USB

Display Setting

Aspect Ratio → Auto 4:3 16:10 16:9 1.85:1 2.35:1

Display Flip → Close Open Close Open
H Flip V Flip

Zoom → Close Zoom x2 Zoom x4

Pixel-to-Pixel → Close Open

HV Delay → Close H Delay V Delay H/V Delay

Freeze → Close Open

Info Display → Duration 5S 10S 30S 60S Always

Battery Notification → Close Open

TimeCode → Close Open

System Config

Menu Config → Language 中文 English
Duration 5s 10s 15s 20s Close

Color → Bright 0 Contr 0
Sharp 0 Satura 0

Color Temperature → Color Temp 5600K 6500K 9300K User
Red 50 Green 50 Blue 50

MENU DESCRIPTION

System Config

Backlight → Backlight Custom

Sound → Volume

History → RGB Wavefo Bright Histo RGB Histogram
 Vectorscope False Color Zebra Single Color
 Peaking Safe Area Mark Ratio
Grid Lines Audio Meters LUT Pixel-to-Pixel

Reset → Aspect Ratio Backlight

Update → Version V0.0.0.0

Status →

Input	HDMI	Resolution	1080P	Scan Mode	LineByLine
Frame	60Hz	Color Temp	6500K	Aspect Ratio	Auto
Backlight	50	Volume	20	RTV1.0	20200106

Wireless Config

Frequency → Scan ☒ ☒ ☒ ☒ ☒ ☒ ☒ ☒ ☒ ☒

Channel

Patrol ☒ ☐ ☐ ☐ ☐ ☒ ☐ ☒ ☒

Wireless Status →

SNR OUT	17	20	AUDIO BER 0	
SNR IN	24	23	23	24
PIN	50	49	51	51
	CHANNEL			CH6 5530

Shortcut

False Color →

Zebra →

Histogram →

	Position	

Peaking →

LUT Config →

Mark Ratio →

Waveform →

	Position	

Audio Meters →

LUT IMPORT TUTORIAL

1. Copy the LOG firmware to a USB flash.
2. Insert the USB flash into the USB interface on the monitor.
3. Find "Custom LUT_usb " in the monitor menu "LUT Config", and click "Look USB".
4. Find the LUT file and open the folder.
5. Click the needed LUT file. When a " " appears on the selected file, it means the LUT file has been imported successfully.
6. After importing the required LUT file, click "exit USB" and pull out the USB flash.

DEVICE UPGRADE

1. Copy the upgrade firmware to a USB flash;
2. Insert the USB flash into the monitor USB interface on the monitor.
3. Find "Update" in "System Config" in the monitor menu, and click "Update" to confirm.
4. The power indicator on the top of the monitor will flash with red light and green light alternately.
5. After the program is upgraded, the monitor will restart automatically.

PARAMETERS

Screen Dimension	7 Inch
Dimension	(L*W*H): 192*120*24mm Excluding external antenna and battery buckle
Net Weight	750g (without handle)
Physical Resolution	1920*1200
Contrast Ratio	1100:1
Brightness	1500 nits
Viewing Angle	178°
Backlight	Highlight
Voltage	7~36V DC
Power Consumption	<19W
Audio Output	3.5mm Headphone Interface
Video Format	480P@60Hz 576P@50 Hz 720P@60,50 Hz 1080P@60,50 Hz 1080P@23.98,24,25,29.97,30Hz 1080i@60,50 Hz 1080Psf@23.98,24,25,29.97,30 Hz 1080P60/59.94/50(Level A) 1080P60/59.94/50(Level B) 1080i60/59.94/50 1080P30/29.97/25/24/23.98
Frequency	5GHz
Modulation Mode	OFDM
Receiving Sensitivity	-75dBm
Bandwidth	40MHz

■ CONNECTION ISSUES

1. Check and make sure that the power supply works fine on the monitor.
2. Change the battery in time if the low battery warning sign starts to flash on the top of the screen.
3. Check the signal strength, try to change to another channel, and to connect again if the signal is weak. .
4. Make sure the transmitter and the wireless monitor are on the same channel.

■ DISPLAY ISSUES

1. Check if the video source is correctly connected to the HDMI IN or SDI IN interface.
2. Check if the OLED shows the video format. If not, check if the HDMI/SDI cable connected to transmitter is correctly linked with the camera and if the camera has the video output.
3. Check if the format of the camera output interface is compatible with this system.

■ LOW-QUALITY IMAGE ISSUE

1. Make sure both the transmitter and the receiver are installed at least 1.5m above the ground
2. Check the wireless status. If the pin value is greater than 60, it means the wireless signal strength is too weak. Change to another channel or shorten the connection distance between the transmitter and the wireless monitor.



 HollylandTech

 HollylandTech

 HollylandTech

 sales@Hollyland-tech.com

 www.hollyland-tech.com

SHENZHEN HOLLYLAND TECHNOLOGY CO., LTD

8F, 5D Building, Skyworth Innovation Valley, Tangtou, Shiyan, Baoan District Shenzhen, China.