



# Pyro H

## Quick Guide

V1.0.0

## Foreword

Thank you for choosing the **Pyro H** wireless high-definition video transmission system. The product adopts the latest codec technology, as well as 2.4 GHz and 5 GHz wireless transmission technology, achieving a super-low latency video transmission.

**EN** Please read this Quick Guide carefully. We wish you a pleasant experience. To obtain Quick Guide information in other languages, please scan the QR code below.



## Key Features

- In Broadcast mode, one transmitter can connect up to four receivers.
- Wireless transmission on 2.4 GHz and 5 GHz frequency bands.
- Minimum latency of 60ms in an interference-free environment (1080P60\*).
- 1300ft (400m) LOS range\* (Connection to the app may affect the transmission range).
- 650ft (200m) LOS range\* (Broadcast mode).
- Transmitter supports HDMI Input and HDMI Loopout.
- HDMI supports transmission at 4K/30fps.
- Multiple power supply options, including DC (locking), NP-F battery, and USB-C (Charging via USB-C at a minimum of 5V/2A will restart the device; this power supply option is not supported in Broadcast mode).
- Receiver supports USB Video Class (UVC).
- Upon startup, a quality frequency channel will be automatically chosen. Intelligent frequency scan function on receiver can display the current frequency status, allowing you to choose a desired channel. (When in Broadcast mode, the frequency scan function can only detect interference caused by equipment not in Broadcast mode. Equipment in Broadcast mode need to choose different frequency channels to avoid interference.)

\* The related data is based on Hollyland laboratory test results.

## Configuration

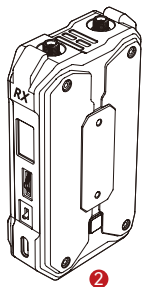
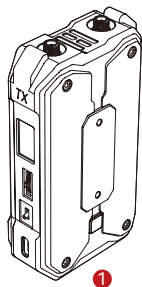

3

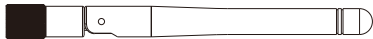

4



5

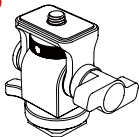

6

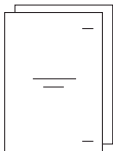

7

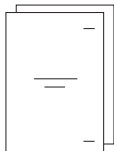

8



9



## Configuration

SKU	One Transmitter & One Receiver	One Transmitter	One Receiver
① Transmitter	1	1	/
② Receiver	1	/	1
③ Cylindrical Antenna (2.4 GHz & 5 GHz)	5	2	2
④ USB-C OTG Adapter	1	1	1
⑤ Rotatable Cold Shoe Mount	1	1	/
⑥ Quick Guide & Packing List Card	1	1	1
⑦ Warranty Card & Compliance Information	1	1	1
⑧ 12V/2A DC Power Adapter	/	/	/
⑨ Screw Fitting for Stabilizer	/	/	/

Note:

1. The quantity of the items depends on the product configuration detailed on the packing list card.
2. You can buy a transmitter, receiver, cylindrical antenna, rotatable cold shoe mount, DC power adapter, and screw fitting for stabilizer from Hollyland's official website based on your needs.

## Connection

- One transmitter can connect to two receivers and two mobile devices

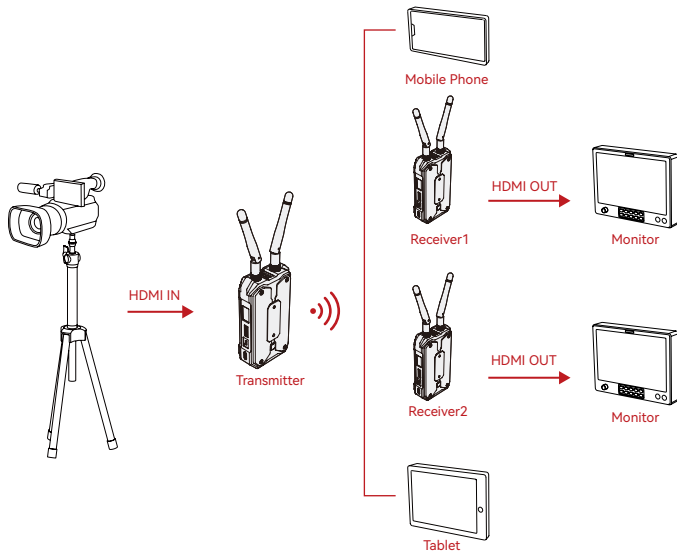

## Connection

- Broadcast mode enabled (one transmitter can connect up to four receivers)

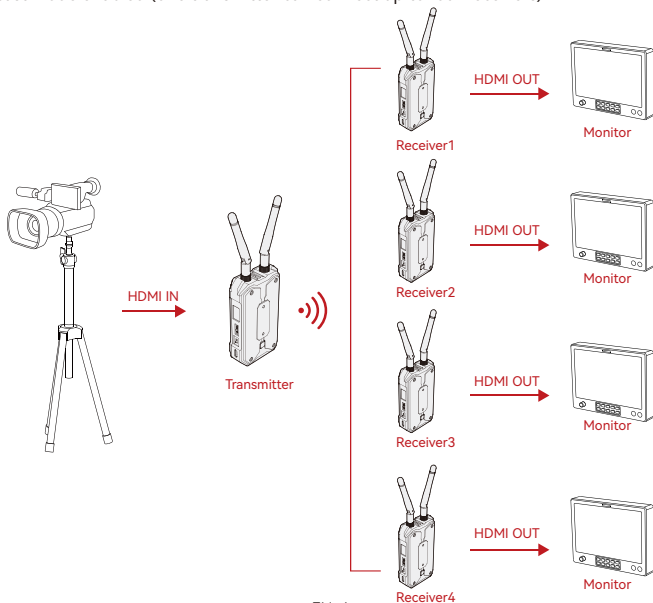

# Overview

## Transmitter

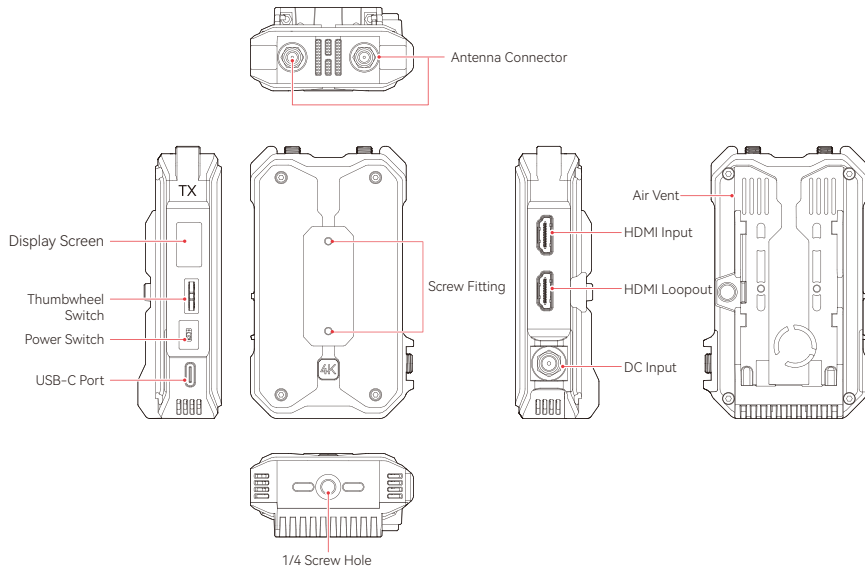



# Overview

## Receiver

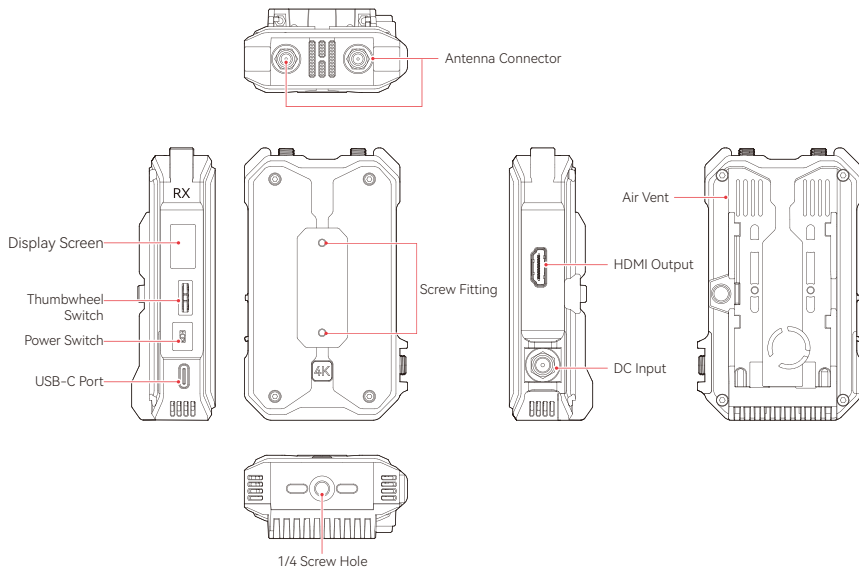

# Installation

## Transmitter

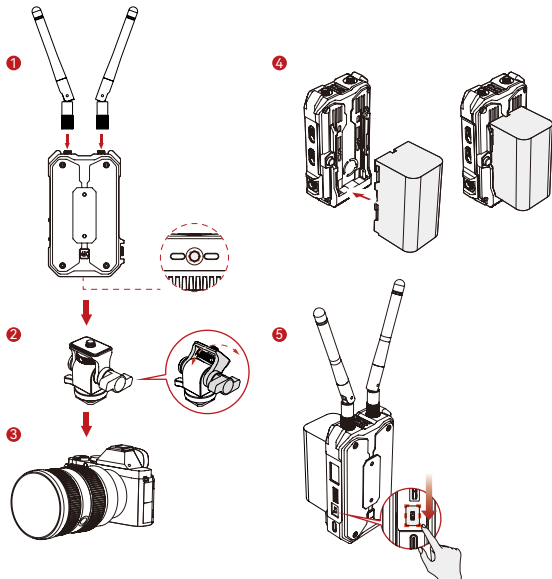

1. Install the antennas as shown in the diagram.
2. Mount the transmitter to the camera using the rotatable cold shoe mount.
3. Connect the transmitter to the camera using the HDMI cable.
4. Install the battery (NP-F batteries).
5. Toggle the power switch downward to turn on the transmitter.

# Installation

## Receiver

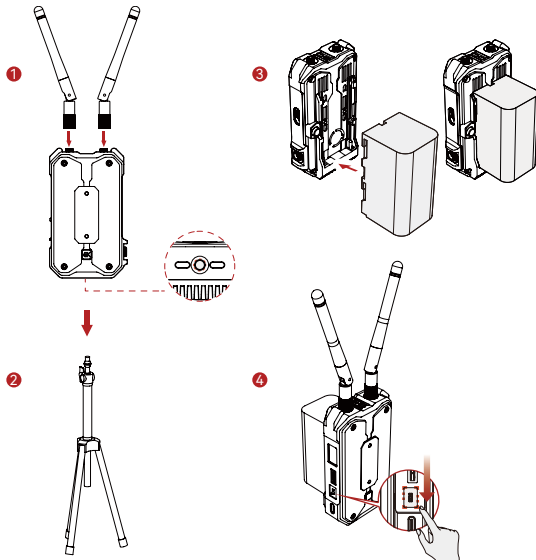

1. Install the antennas as shown in the diagram.
2. Mount the receiver on the tripod using the 1/4 screw hole at the bottom.
3. Install the battery (NP-F batteries).
4. Toggle the power switch downward to turn on the receiver.

# Interface Introduction

## Home Screen Introduction

### Transmitter

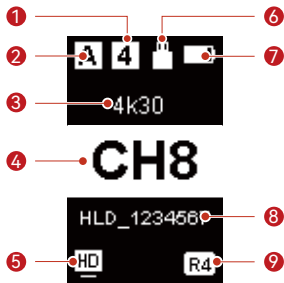

### Receiver

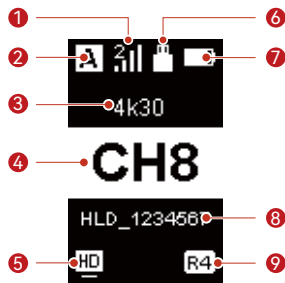

① Transmitter: number of the connected receivers Receiver: signal strength	⑥ USB-C Port Status
② Current Group	⑦ Battery Level
③ Video Resolution & Frame Rate	⑧ Wi-Fi Account
④ Frequency Channel (scroll the thumbwheel switch up and down to change the channel)	⑨ Broadcast Mode Icon (not displayed when Broadcast mode disabled)
⑤ Scene Mode Icon	

# Funtions Introduction

## Entering the Menu

Press and hold the thumbwheel switch for 3 seconds to enter the menu. Scroll the switch up and down to select the function and press the switch to confirm.

## ■ Transmitter functions description



### Scene Mode

Provides multiple scene modes to meet your needs.



### Group Pairing

Transmitter and receiver in the same group automatically pair.



### System Settings



### HD Mode

Bit rate at up to 12Mbps for high-definition transmission.



### Fan Setting

Provides different modes to meet your heat dissipation needs.



### Net Information

For viewing Wi-Fi account and password.



### Smooth Mode

Latency as low as 60ms.



### Broadcast Mode

If enabled, one transmitter can connect up to four receivers.



### Reset

For resetting to the default settings.



### Return



### Frozen Frame

Controls whether the last frame after a transmission interruption is the final frame from the signal source.



### Version Information

For viewing version information.

# Functions Introduction

## Receiver functions description



### Frequency Scan

For viewing the current interference status. Press the thumbwheel switch to choose the desired channel.



### Group Pairing

Transmitter and receiver in the same group automatically pair.



### System Settings



### Net Information

For viewing Wi-Fi account and password.



### Reset

For resetting to the default settings.



### Version Information

For viewing version information.



### Return

# HollyView App

## ■ App Download and Connection

### 1. Hollyview download

The app HollyView is available for download on Hollyland's official website. Android users also can download the app from the Google Play Store and other App Stores, while iOS users can download from the App Store.



### 2. Connection

To connect to the transmitter, access the Wi-Fi connection interface on your mobile phone, tap the one named HLD plus device ID number, and enter the password (default password: 12345678). You also can scan the QR code on the transmitter through the app to establish connection. If the default Wi-Fi password is changed, connection via QR code will not work. After successful connection, you can use the app to monitor.

## Specifications

	Transmitter	Receiver
Port	<ul style="list-style-type: none"> <li>• DC Input: 2.0mm Core Socket</li> <li>• HDMI Input: HDMI 1.4b</li> <li>• HDMI Loopout: HDMI 1.4b</li> <li>• USB-C: USB 2.0 OTG</li> <li>• Antenna: SMA Male</li> </ul>	<ul style="list-style-type: none"> <li>• DC Input: 2.0mm Core Socket</li> <li>• HDMI Output: HDMI 1.4b</li> <li>• USB-C: USB 2.0 OTG</li> <li>• Antenna: SMA Male</li> </ul>
Power Supply	<ul style="list-style-type: none"> <li>• USB-C: 5V/2A (not supported in Broadcast mode)</li> <li>• Battery Voltage Range: 6.8 – 8.4V</li> <li>• DC Voltage Range: 6 – 16V</li> </ul>	<ul style="list-style-type: none"> <li>• USB-C: 5V/2A (not supported in Broadcast mode)</li> <li>• Battery Voltage Range: 6.8 – 8.4V</li> <li>• DC Voltage Range: 6 – 16V</li> </ul>
Power Consumption	< 7W	< 4W
Net Weight	192g	192g
Dimensions	L × W × H: 109 × 62.3 × 33.4mm (4.3 × 2.45 × 1.3in.)	
Input/Output Format	<ul style="list-style-type: none"> <li>• <b>HDMI</b> 720p50/59.94/60 1080i50/59.94/60 1080p23.98/24/25/29.97/30 1080p50/59.94/60 4K30/25/24</li> <li>• <b>HDMI Loopout</b> 720p50/60 1080i50/60 1080p24/25/30 1080p50/60 4K30/25/24</li> </ul>	<ul style="list-style-type: none"> <li>• <b>HDMI</b> 720p50/60 1080i50/60 1080p24/25/30 1080p50/60 4K30/25/24</li> </ul>



## Specifications

Operating Frequency	<ul style="list-style-type: none"><li>• 5 GHz Frequency Band 5.150 – 5.250 GHz 5.250 – 5.350 GHz 5.470 – 5.725 GHz 5.725 – 5.850 GHz</li><li>• 2.4 GHz Frequency Band 2.412 – 2.484 GHz</li></ul>	
Transmit Power	< 23 dBm	/
Receiver Sensitivity	/	-85 dBm (Broadcast: -80 dBm)
Latency	≤ 60ms	
Bandwidth	20 MHz (Broadcast: 40 MHz)	

Note: Due to differences in various countries and regions, there may be variations in the operating frequency bands and wireless transmission power of the product. For details, please refer to local laws and regulations.

# Support

If you encounter any problems in using the product or need any help, please contact Hollyland Support Team via the following ways:



Hollyland User Group



HollylandTech



HollylandTech



HollylandTech



support@hollyland.com



www.hollyland.com

## Statement:

All copyrights belong to Shenzhen Hollyland Technology Co., Ltd. Without the written approval of Shenzhen Hollyland Technology Co., Ltd., no organization or individual may copy or reproduce part or all of any written or illustrative content and disseminate it in any form.

## Trademark Statement:

All the trademarks are owned by Shenzhen Hollyland Technology Co., Ltd.

## Note:

Due to product version upgrades or other reasons, this Quick Guide will be updated from time to time. Unless otherwise agreed, this document is provided as a guide for use only. All representations, information, and recommendations in this document do not constitute warranties of any kind, express or implied.

# **HOLLYVIEW**

**Powered by Hollyland**

**Manufacturer:** Shenzhen Hollyland Technology Co., Ltd.  
**Address:** 8F, 5D Building, Skyworth Innovation Valley, Tangtou Road,  
Shiyan Street, Baoan District, Shenzhen, 518108, China  
**MADE IN CHINA**

P/N : 3003080465