



# Cosmo C2

User Manual

V1.0

## Foreword

Thank you for choosing the **Cosmo C2** wireless high-definition video transmission system. The product adopts Hollyland's latest self-developed HEVO 2.0 wireless transmission technology, achieving seamless switching between frequency channel and ultra-low latency video transmission.



Scan the QR code to get more  
details of the User Manual

# Key Features

## ■ Key Features

- Supports one receiver connected to up to two transmitters
- The latest self-developed HEVO 2.0 wireless transmission technology provides ultra-high stability and seamless frequency hopping
- Ultra-low latency, as low as 33ms (1080P60 \*)
- Supports 3280ft(1000m) wireless transmission range
- Transmitter supports HDMI IN, SDI IN, and SDI LOOP OUT
- Receiver supports HDMI OUT A, SDI OUT A, HDMI OUT B, and SDI OUT B
- HDMI/SDI port supports 1080P60 input and output
- HDMI/SDI port supports fractional frame rate input and output
- Supports dual UVC streaming outputs (1080P60) on the receiver (Dual-stream capture is not supported on macOS)
- Receiver's Ethernet port supports NDI transmission protocol and RTMP streaming
- Supports low-frame-rate conversion output on the receiver (Signals like P24/P25 can be converted to P60 output, with the same smoothness as P60 output)
- Supports multiple power supply options: DC power adapter (locking) + NP-F batteries for the transmitter, DC power adapter (locking) + V-Mount batteries plate for the receiver
- Supports point-to-point pairing

**Note:** The related data is based on Hollyland laboratory test results.

# Configuration

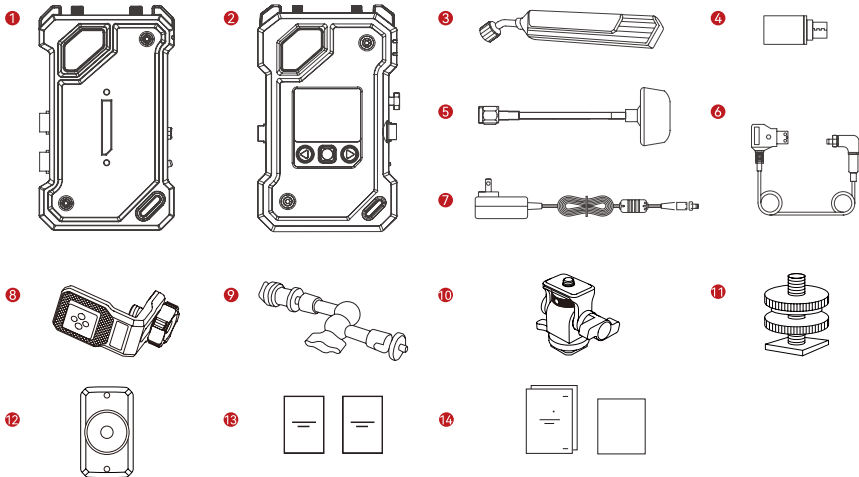

# Configuration

SKU	2 TX & 1 RX	1 TX & 1 RX	1 TX
① Transmitter (TX)	2	1	1
② Receiver (RX)	1	1	-
③ Blade Antenna	7	5	2
④ USB-C OTG Adapter	1	1	1
⑤ Mushroom Antenna	-	-	-
⑥ D-tap to DC Cable (locking)	-	-	-
⑦ DC Power Adapter	1	1	-
⑧ Screw Fitting for Stabilizer	-	-	-
⑨ Magic Arm (5-inch)	-	-	-
⑩ Rotatable Cold Shoe Mount	-	-	-
⑪ Cold Shoe	2	1	-
⑫ Expansion Accessory	2	1	-
⑬ Warranty Card & Compliance Information	1	1	1
⑭ Quick Guide & Packing List Card	1	1	1

**Note:**

1. The quantity and appearance of items depend on the product configuration, the actual packing list card shall prevail.
2. You can buy the above mentioned accessories separately from the Hollyland's official website if necessary.

# Overview

## Transmitter

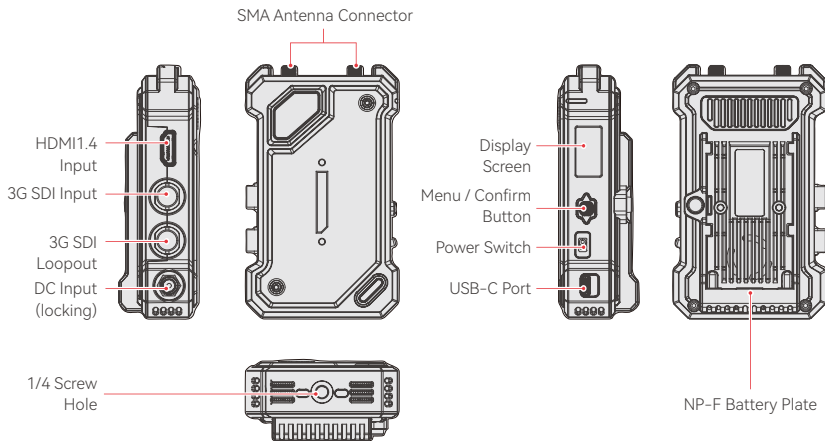

# Overview

## Receiver

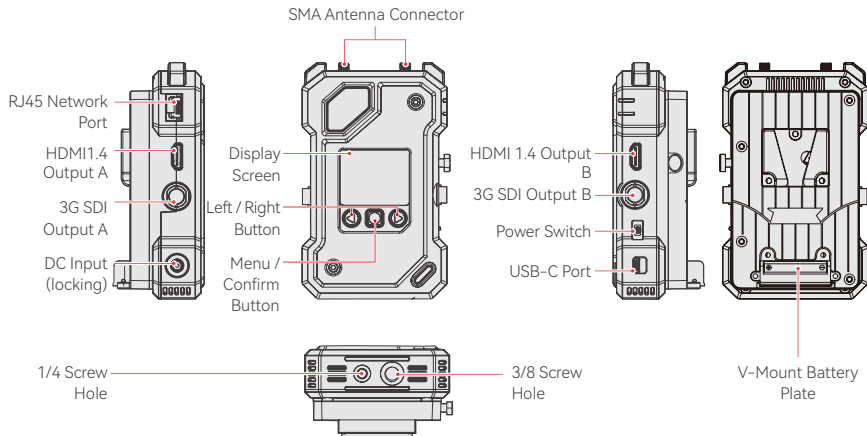

# Installation

## ■ Transmitter

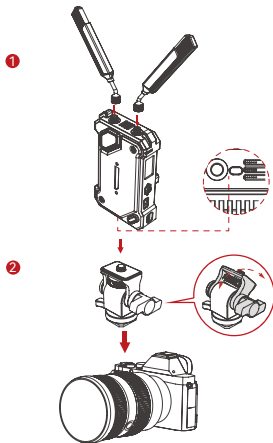

1. Install the antennas as shown in the diagram.
2. Mount the transmitter to the camera using the magic arm, rotatable cold shoe mount or other accessories.

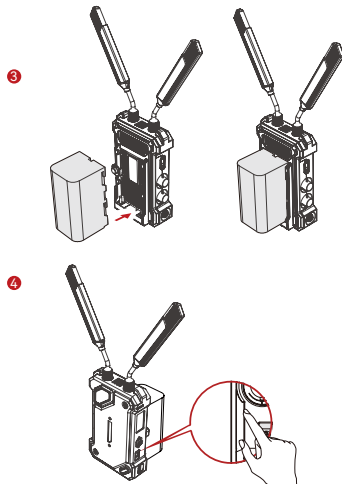

3. Install the battery (Support NP-F batteries or DC power adapter)
4. Toggle the power switch downward to turn on the transmitter.



# Installation

## Receiver

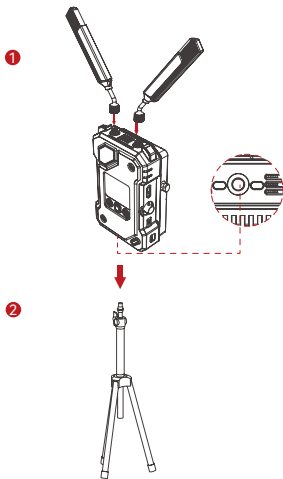

1. Install the antennas as shown in the diagram
2. Mount the receiver on the tripod using the 1/4 screw hole or 3/8 screw hole at the bottom.

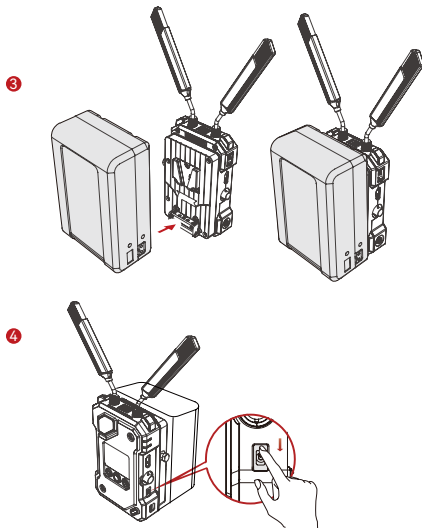

3. Install the battery (Support V-Mount battery or DC power adapter).
4. Toggle the power switch downward to turn on the receiver.

# Home Screen Introduction

## Transmitter

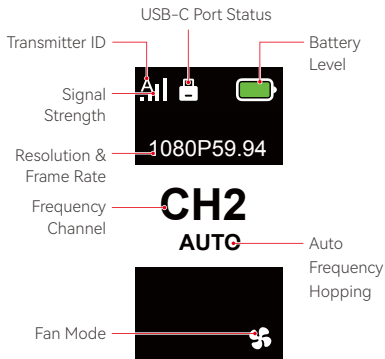



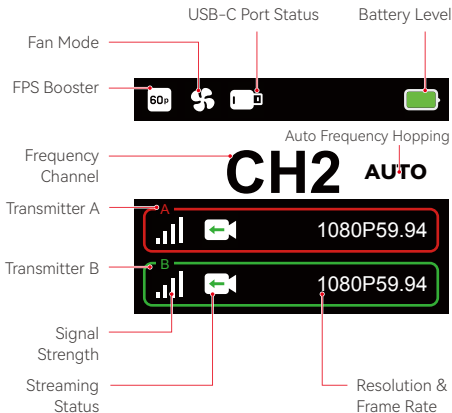





## Receiver











Press and hold the menu button for 3 seconds to enter the menu interface. Use the up and down buttons to switch between menu options, and press the menu button to confirm your selection.

## ■ TX Indicator Lights

	Red light steady		Unpaired / Signal Lost
	Red light flashing slowly		Battery is below 15% (approximately 30 minutes of usage remaining)
	Red light flashing		Battery is below 5% (approximately 10 minutes of usage remaining)
	Green light steady		Successfully paired and signal is stable

## ■ RX Indicator Lights

	Red light steady		Unpaired / Signal Lost
	Red light flashing slowly		Battery is below 15% (approximately 30 minutes of usage remaining) — both lights will flash
	Red light flashing		Battery is below 5% (approximately 10 minutes of usage remaining) — both lights will flash
	Green light steady		Successfully paired and signal is stable (top light for Transmitter A, bottom light for Transmitter B)

## ■ Transmitter Functions Description



### Pairing

Click to enter pairing mode, and the receiver must also enter pairing mode for successful pairing.



### Fan Settings

Select different fan modes based on varying cooling requirements.



### System Settings

View system-related setting information.



### Language Switch

Switch between Chinese and English.



### Version Information

Check the software and hardware version of the system.



### Reset

Resets to default settings.

## Receiver Function Description



### Pairing

Click to enter pairing mode, and the receiver must also enter pairing mode for successful pairing.



### Frequency Scanning

After scanning, you can select high-quality frequency channel by pressing buttons or activate the auto-hopping function.



### Fan Settings

You can select different fan modes based on varying cooling requirements.



### FPS Booster

The RX will convert incoming low frame rate signals, such as P24, P25, or P30, into P60 to reduce transmission latency.



### Streaming

Choose different streaming methods based on your needs, which will provide you with varying performance experiences.

**Note:** Activating the streaming mode will impact the latency of regular video transmission.



### Web Information

View the device's IP address.



### Return



### System Settings

View system-related setting information.



### Frozen Frame

Controls whether the last frame after a transmission interruption is the final frame from the signal source.



### Language Switch

Switch between Chinese and English.



### Version Information

Check the software and hardware version of the system.



### Reset

Resets to default settings.

## ■ Customize Frozen Frame

To customize the frozen frame, the following conditions must be met:

1. Image Format: JPG
2. Resolution: 1920 x 1080
3. Image Name: logo.JPG
4. Size: Within 1MB

Import the image that meets the above conditions into the root directory of the USB drive. Insert the USB drive into the receiver while it is powered on and wait for it to load.

### Gateway Settings (Using a switch can achieve the same effect)

#### ■ Operation Guide

1. Connect the receiver to the computer using an Ethernet cable.
2. Right-click on the "Network" and select "Properties."

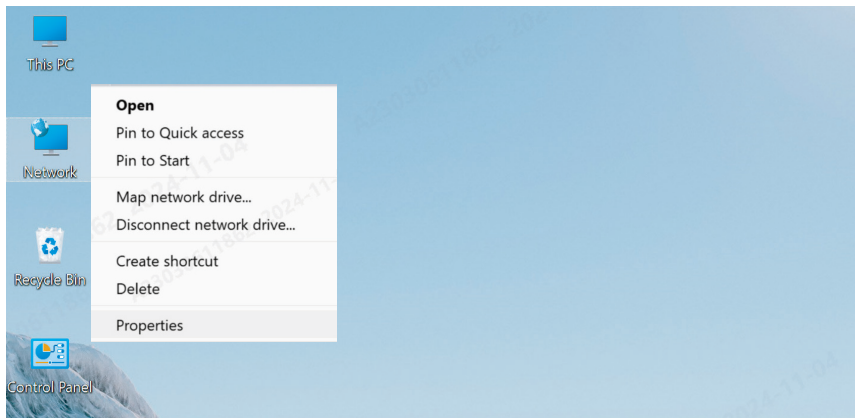

3. Click on "Ethernet."



### View your basic network information and set up connections

#### View your active networks

**y6cd7.com**

Public network

Access type: Internet

Connections: WLAN (Guest\_05)

**未识别的网络**

Public network

Access type: No Internet access

Connections: Ethernet

#### Change your networking settings



[Set up a new connection or network](#)

Set up a broadband, dial-up, or VPN connection; or set up a router or access point.



[Troubleshoot problems](#)

Diagnose and repair network problems, or get troubleshooting information.



## Product Usage

4. Click on "Properties".

5. Click on "Internet Protocol Version 4 (TCP/IPv4)," then click on "Properties."

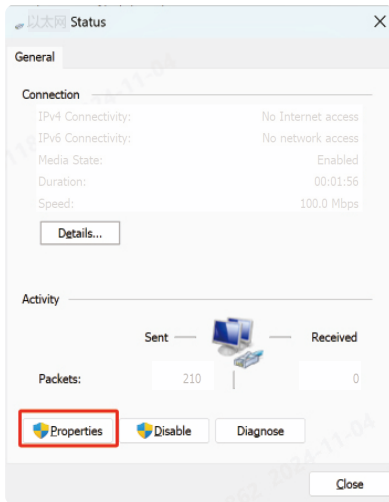

(3)

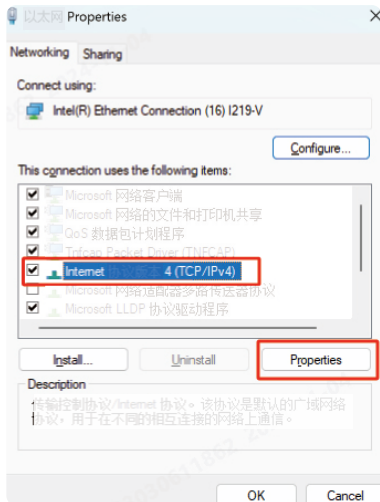

(4)

## Product Usage

- Choose "Use the following IP address," input the IP address, subnet mask, and default gateway as shown in the receiver's Web information to ensure they are on the same network, then click "OK"
- Click "Close."

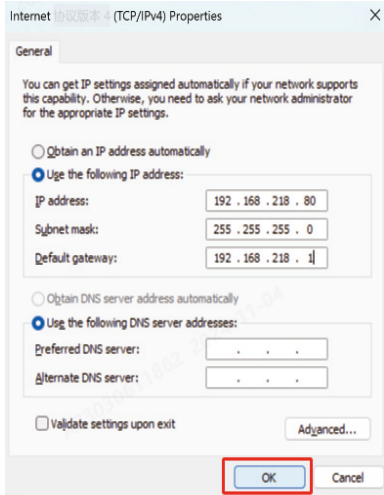

(5)

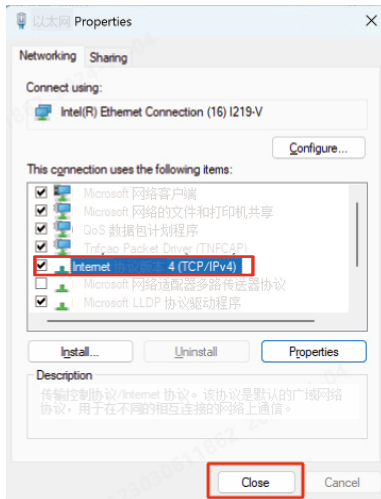

(6)

### RTMP Streaming – 4G LTE Wi-Fi Modem

#### ■ Operation Guide

1. Connect the device.
2. Connect the receiver to the computer using an Ethernet cable, ensuring that the computer and receiver are on the same gateway (for details, refer to Gateway Settings).
3. Connect a 4G LTE Wi-Fi modem capable of internet connectivity to the transmission receiver using an OTG adapter.
4. Check for any changes at the corresponding USB-C icon:



Network Connected



Streaming



Streaming Interrupted

5. Access the **Web Information** interface through the receiver to view the IP address.
6. Open a browser on a PC or mobile device and enter the receiver's IP address.

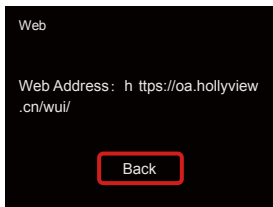

Web Information

7. After entering the page, input the streaming URL and key for the live streaming platform to start streaming.



中文English

Log Out

Settings

Device RTMP Streaming Settings

TX-A

\*RTMP Streaming Address

hollyand.video/live/555

Key

Please enter the key

Start Streaming

TX-B

\*RTMP Streaming Address

hollyand.video/live/555

Key

Please enter the key

Start Streaming

Device Channel

Current Channel

13

Start Scanning Channels

EN-19

### RTMP Streaming – Local Area Network

#### ■ Operation Guide

1. Connect the device.
2. Connect the receiver to the internet or router using an Ethernet cable.
3. Access the **Web Information** through the receiver to view the IP address.
4. Ensure the PC or mobile device is connected to the same local area network segment as the receiver via Ethernet or Wi-Fi.
5. Open a browser on the PC or mobile device and enter the receiver's IP address.

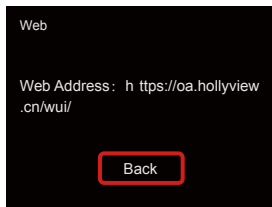

Web Information

6. After entering the page, input the streaming URL and key for the live streaming platform to start streaming.

The screenshot displays the HOLLYLAND web interface. At the top left is the HOLLYLAND logo. To its right are language selection buttons for '中文' and 'English'. At the top right is a 'Log Out' button. On the left side, there is a 'Settings' button with a gear icon. The main content area is divided into two sections. The first section, titled 'Device RTMP Streaming Settings', contains two identical configuration boxes labeled 'TX-A' and 'TX-B'. Each box has a label for 'RTMP Streaming Address' and a text input field containing 'hollyland.video/live/555'. Below this is a label for 'Key' and a text input field with the placeholder 'Please enter the key'. At the bottom right of each box is an orange 'Start Streaming' button. The second section, titled 'Device Channel', is located below the first. It features a label 'Current Channel' followed by a dropdown menu showing '13' and a downward arrow. To the right of the dropdown is an orange 'Start Scanning Channels' button.

**HOLLYLAND** 中文 English Log Out

Settings

### Device RTMP Streaming Settings

**TX-A**

\*RTMP Streaming Address

hollyland.video/live/555

Key

Please enter the key

Start Streaming

**TX-B**

\*RTMP Streaming Address

hollyland.video/live/555

Key

Please enter the key

Start Streaming

### Device Channel

Current Channel 13 ▼ Start Scanning Channels

## NDI Streaming (Using OBS as an Example)

### ■ Operation Guide

1. Keep the computer and the receiver on the same gateway (for details, refer to Gateway Settings).
2. Disconnect the network.

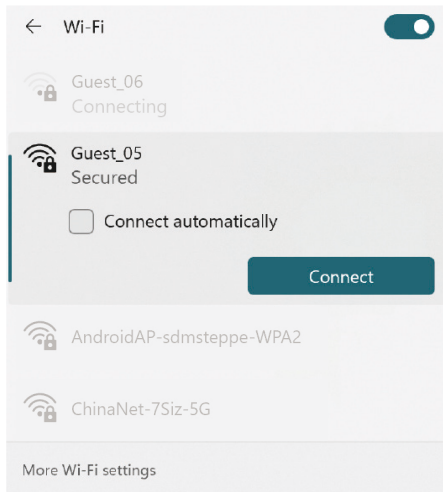

## Product Usage

3. Open the OBS software with the installed OBS-NDI.
4. Click to add a video source.

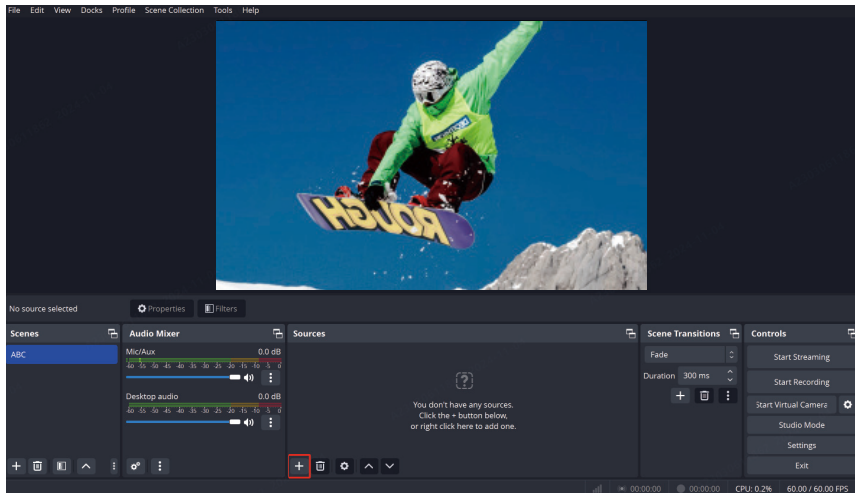



# Product Usage

5. Add NDI source and confirm.

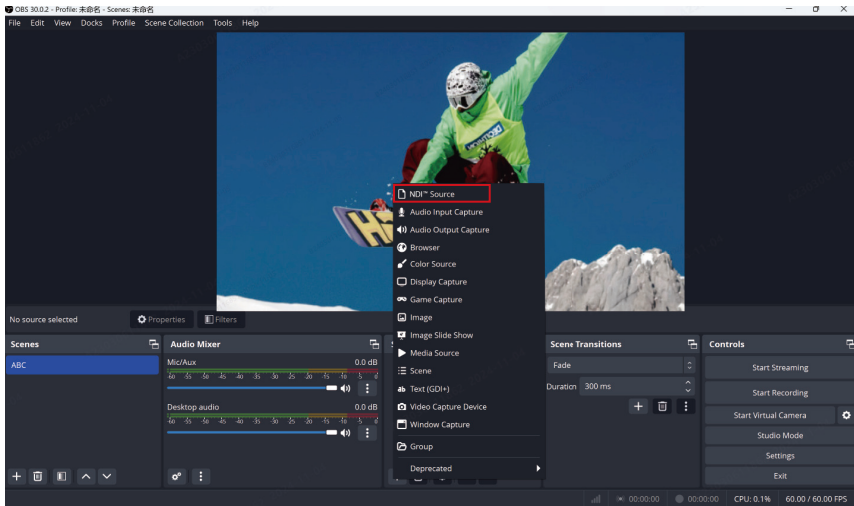

## Product Usage

6. Select the corresponding video source and confirm.

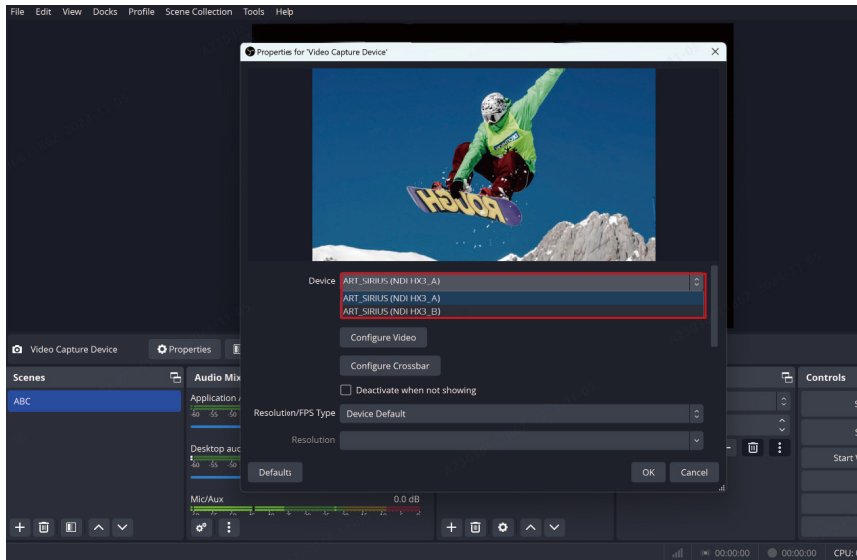

### 7. Connect the Internet.

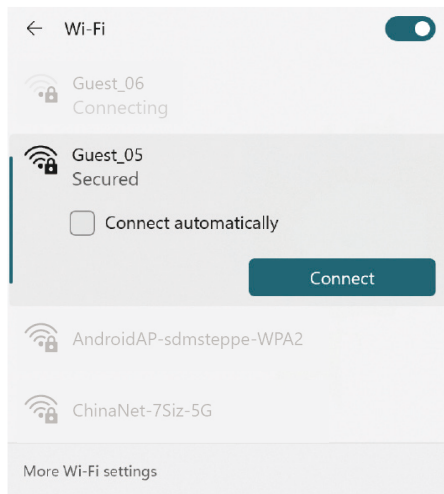

# Product Usage

## 8. Start streaming.

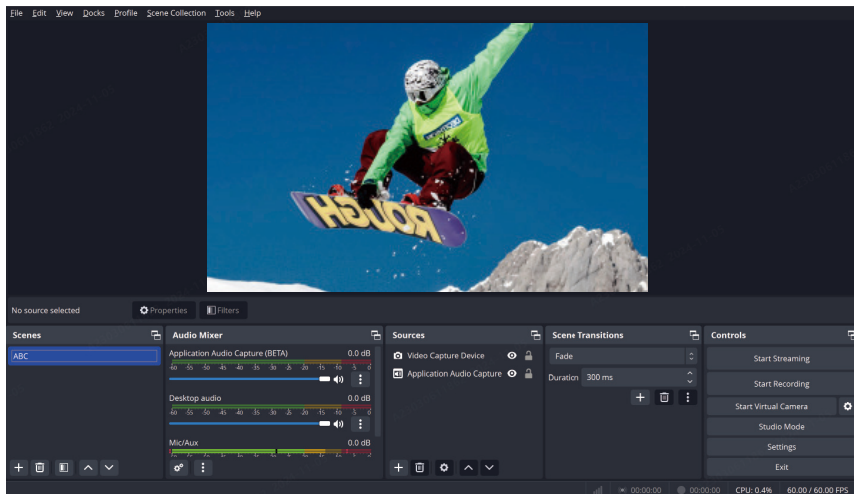

## Specifications

	Transmitter	Receiver
Port	DC Input: 2.0mm Core Socket HDMI Input: HDMI 1.4b SDI Input: 3G SDI SDI Loopout: 3G SDI USB-C: USB 2.0 OTG Antenna: SMA Male	DC Input: 2.0mm Core Socket HDMI Output: HDMI 1.4b × 2 SDI Output: 3G SDI × 2 USB-C: USB 2.0 OTG Antenna: SMA Male Ethernet Port: RJ45, 100 Mbps
Power Supply	NP-F Battery Voltage Range: 6.8 – 8.4V DC Voltage Range: 6 – 16V	V-Mount Battery Voltage Range: 11.8 – 16.8V DC Voltage Range: 6 – 16V
Power Consumption	<10W	<11W
Net Weight	210g	440g
Dimensions (L × W × H)	114.8 × 69 × 35.5mm (4.5 × 2.7 × 1.4")	142 × 87.2 × 33.2mm (5.6 × 3.4 × 1.3")
Operating Frequency	5.15 – 5.85 GHz	
Transmit Power	< 23 dBm	/
Receiver Sensitivity	/	-90 dBm
Latency	≥ 33ms	
Bandwidth	40 MHz	

## Specifications

HDMI Input	HDMI Output	SDI Output
720p50/59.94/60	720p50/59.94/60	720p50/59.94/60
1080i50/59.94/60	1080i50/59.94/60	1080i50/59.94/60
1080p23.98/24/25/29.97/30	1080p23.98/24/25/29.97/30	1080p23.98/24/25/29.97/30
1080p50/59.94/60	1080p50/59.94/60	1080p50/59.94/60

SDI Input	HDMI Output	SDI Loopout /Output
720p50/59.94/60	720p50/59.94/60	720p50/59.94/60
1080i50/59.94/60	1080i50/59.94/60	1080i50/59.94/60
1080p23.98/24/25/29.97/30	1080p23.98/24/25/29.97/30	1080p23.98/24/25/29.97/30
1080p50/59.94/60	1080p50/59.94/60	1080p50/59.94/60

Note: Due to differences in various countries and regions, there may be variations in the operating frequency band and wireless transmit power of the product. For details, please refer to local laws and regulations.

If you encounter any problems in using the product or need any help, please contact Hollyland Support Team via the following ways:



Hollyland User Group



HollylandTech



HollylandTech



support@hollyland.com



HollylandTech



www.hollyland.com

## Statement:

All copyrights belong to Shenzhen Hollyland Technology Co., Ltd. Without the written approval of Shenzhen Hollyland Technology Co., Ltd., no organization or individual may copy or reproduce part or all of any written or illustrative content and disseminate it in any form.

## Trademark Statement:

All the trademarks are owned by Shenzhen Hollyland Technology Co., Ltd.

## Note:

Due to product version upgrades or other reasons, this User Manual will be updated from time to time. Unless otherwise agreed, this document is provided as a guide for use only. All representations, information, and recommendations in this document do not constitute warranties of any kind, express or implied.

# HOLLYVIEW

Manufacturer: Shenzhen Hollyland Technology Co., Ltd.  
Address: 8F, 5D Building, Skyworth Innovation Valley, Tangtou  
Road, Shiyan Street, Baoan District, Shenzhen, 518108, China

MADE IN CHINA