

CHASING M2 PRO

Quick Start Guide V1.0

- This quick start guide is only for the basic operation of CHASING M2 PRO.
- This content is subject to change without prior notice, you could have the latest user manual by the www.chasing-innovation.com.

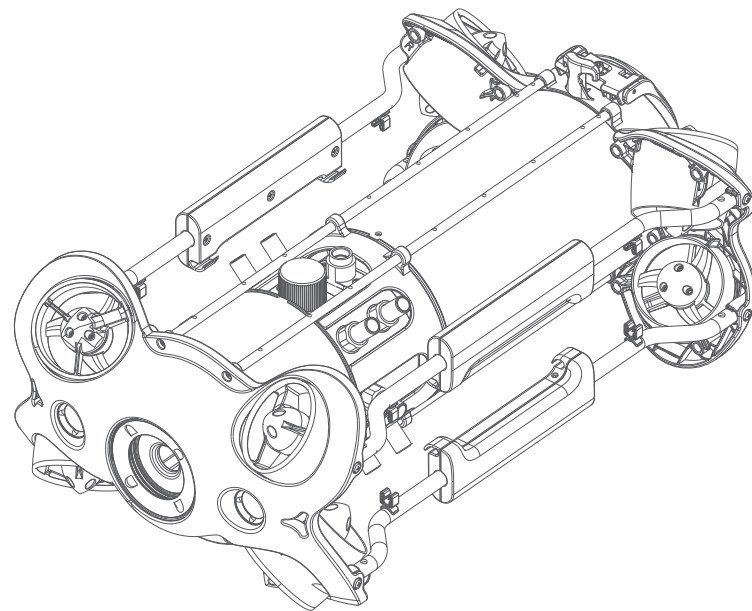

CHASING

Main Parts

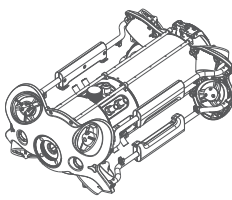

• ROV

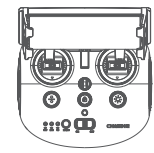

• Remote Controller

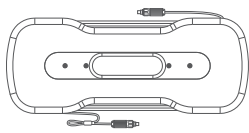

• Tether&Winder

Installation & Connection

① Download CHASING GO1 App

CHASING GO1 App : Scan the following QR code or visit the IOS App Store/Google Play/Chasing website for downloading.
(For IOS 9.0 or later/Android version 4.4 or later)



② Connect ROV with Remote Controller

- Insert one end of the tether connector into the remote controller connector socket.
- Reserve a suitable length and hang the Buckle on the Buckle Bracket, and make it tension.
- Insert the other end of the tether connector to the ROV.
- Securely hand-tighten both connectors.

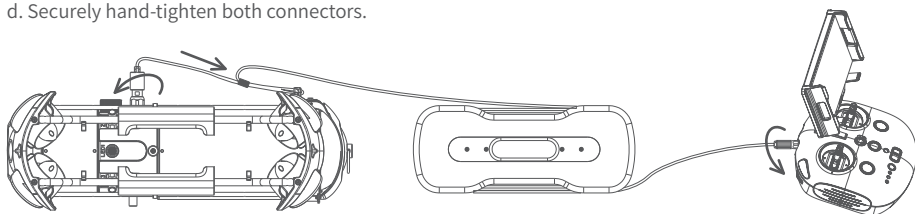

③ Start (turn on) the ROV

- Turn on the remote controller power button.
- A few seconds later, the remote controller's indicator lights up, 5G or 2.4G light will be always on. The drone LED lights will flash shortly, accompanied by two self-tests sounds.
- Check all the connectors and lights pre-dive, and unlock the ROV when everything is ready underwater.

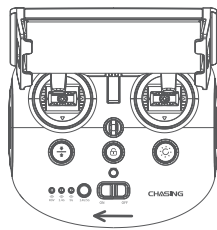

④ Connect remote controller to your phone/tablet

Method 1: USB Direct Cable Connection

Choose an appropriate remote controller cable based on the type of mobile device. A Lightning connector cable, micro USB cable, and TYPE-C cable are included in the packaging. Connect the end of the cable with the mobile phone logo to the mobile device.

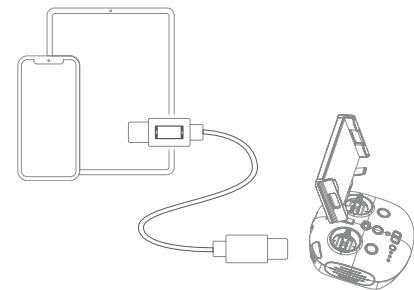

Note: * It is recommended to use this kind of way to connect mobile phone/tablet and remote controller.
* If the connection fails, please try to turn off your phone's Wi-Fi and mobile network. If still fails, it may be a phone/tablet compatibility problem. Please select method 2 Wi-Fi connection. * The remote controller type-c port and attached remote controller cables do not support charging.

Method 2: Wi-Fi Connection

- On the Phone/Tablet, go to Wi-Fi settings.
- Wait for 5-10 seconds and the Chasing_xxxx network will appear as an option.
- Click to connect and enter the Wi-Fi password: 12345678



⑤ App interface Introduction

Open the App and enter the camera, you will see the real-time scene transmission.

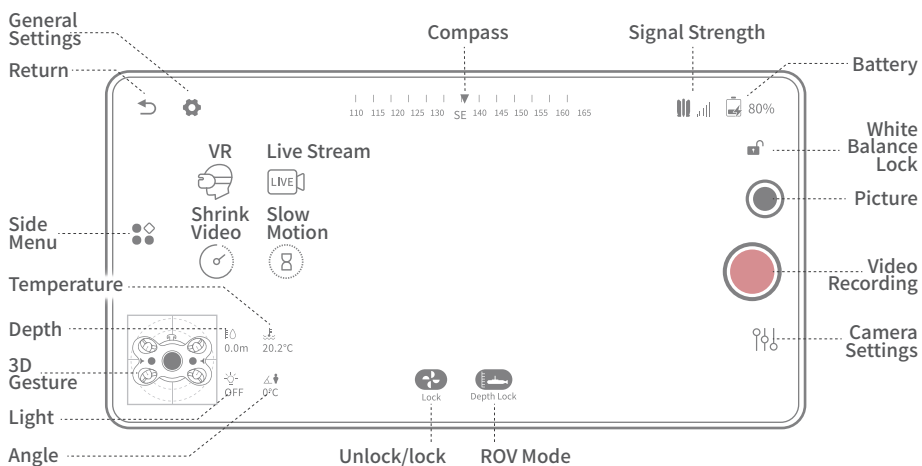

* Note: You could check more guidance videos on the website page <https://www.chasing.com/>, or you could contact the global support team with any questions : support@chasing-innovation.com

⑥ Drop the ROV into Water

- Grasp the grips on both sides of the ROV with both hands and gently throw the ROV into the water.
- Unlock the Thruster(motors) to dive.
- For a better experience, it is recommended to ensure that the water depth exceeds 1 meter.

Maintenance and Precautions

① Navigation Safety

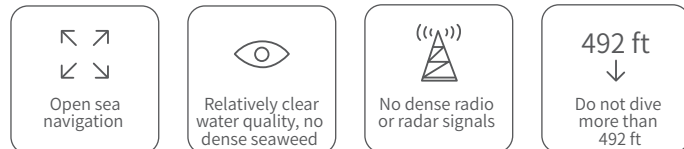

② Battery Protection

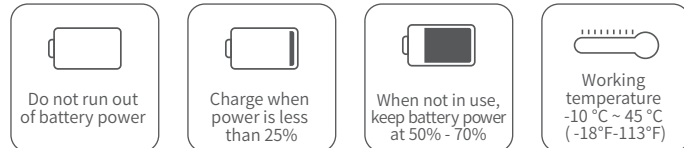

③ Charging Protection

- Only use the Chasing standard adapter.
- Red light means charging.
- Green light means fully charged.

④ Thruster/ Propeller



- Do not touch the propellers of the Thruster
- Do not unlock the Thruster for more than 30 seconds in the air to avoid overheating
- After using the ROV in the salt water, please put it in fresh water for about 1 hour and turn it on, let the drone run for 10 minutes to discharge the salt, and try out the water after cleaning with a towel.

⑤ Connector Sockets /Tether Connectors

- Check the Connector socket and tether pre-dive, keep dry and clean. Salt and moisture may cause corrosion of the connector. Be sure to wash the socket with fresh water if the interface has water stains, and make the connectors dry after cleaning.

⑥ O-ring

- Check whether the O-ring on the tether connector/Battery socket/micro SD card socket pre-dive, and make a replacement when it is missed or damaged.
- It is recommended to grease the o-ring at the interface seal for maintenance each time when the battery cabin and micro SD card are removed and installed

Other

- Do not turn on the LED lights before entering the water to avoid damages.
- Check if the Thrusters/propellers are getting stuck by seaweed or external matters, rinse the ROV with fresh water and then dry and put it back in the packing box.
- Remote control cannot be washed with water, please clean it with towel.
- The pull ring at the end of the battery can only be used to remove the battery, not to lift the ROV, otherwise it may damage the ROV.
- Do not place heavy objects on drone or accessories to avoid possible damage.
- People under the age of 16 should only use this drone under adult supervision.
- When not in use, please do not expose the drone and accessories under sunlight. Store it in a cool place or in a special box.
- Chloride or other chemicals can erode Chasing M2 PRO. Do not use if the pool is under high chlorine level.

Support

- Any questions about our products please contact by support@chasing-innovation.com or leave a message on the Chasing Website (<https://www.chasing.com>) chatting window.
- You can also join the OFFICIAL CHASING OWNERS GROUP on Facebook for latest news, app update and other shared stories with Chasing Products worldwide.

www.chasing.com
support@chasing-innovation.com